

Instructions on the Assembly of Sides to Floor Wardrobes (Type C)

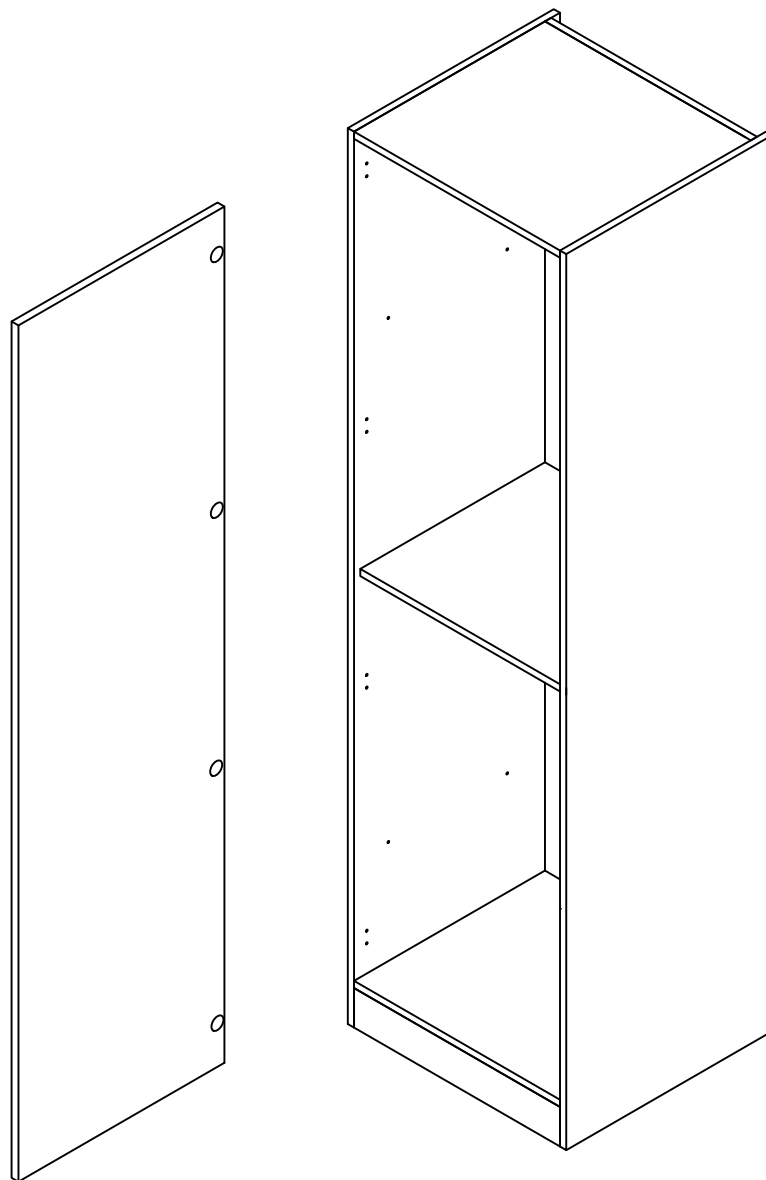

Note: All measurements in mm (millimeters).

Regardless of width the construction remains the same.

Standard height robe is 2255 high, 580 deep, 100 high integral plinth.

Each robe is supplied with a shelf for a choice of 3 positions or can be disregarded.

All robes come with a 25mm void at rear allowing for scribing over skirting boards.

For illustration purposes a 600mm wide robe is shown and all of its associated parts.

All panels are 18mm thick. Door thickness vary per manufacturer.



DIY Homefit Ltd.
5a Stanhope Gate
Camberley
Surrey GU15 3DW Phone:
01276 500102 Fax: 01277
660300
www.diyhomefit.co.uk

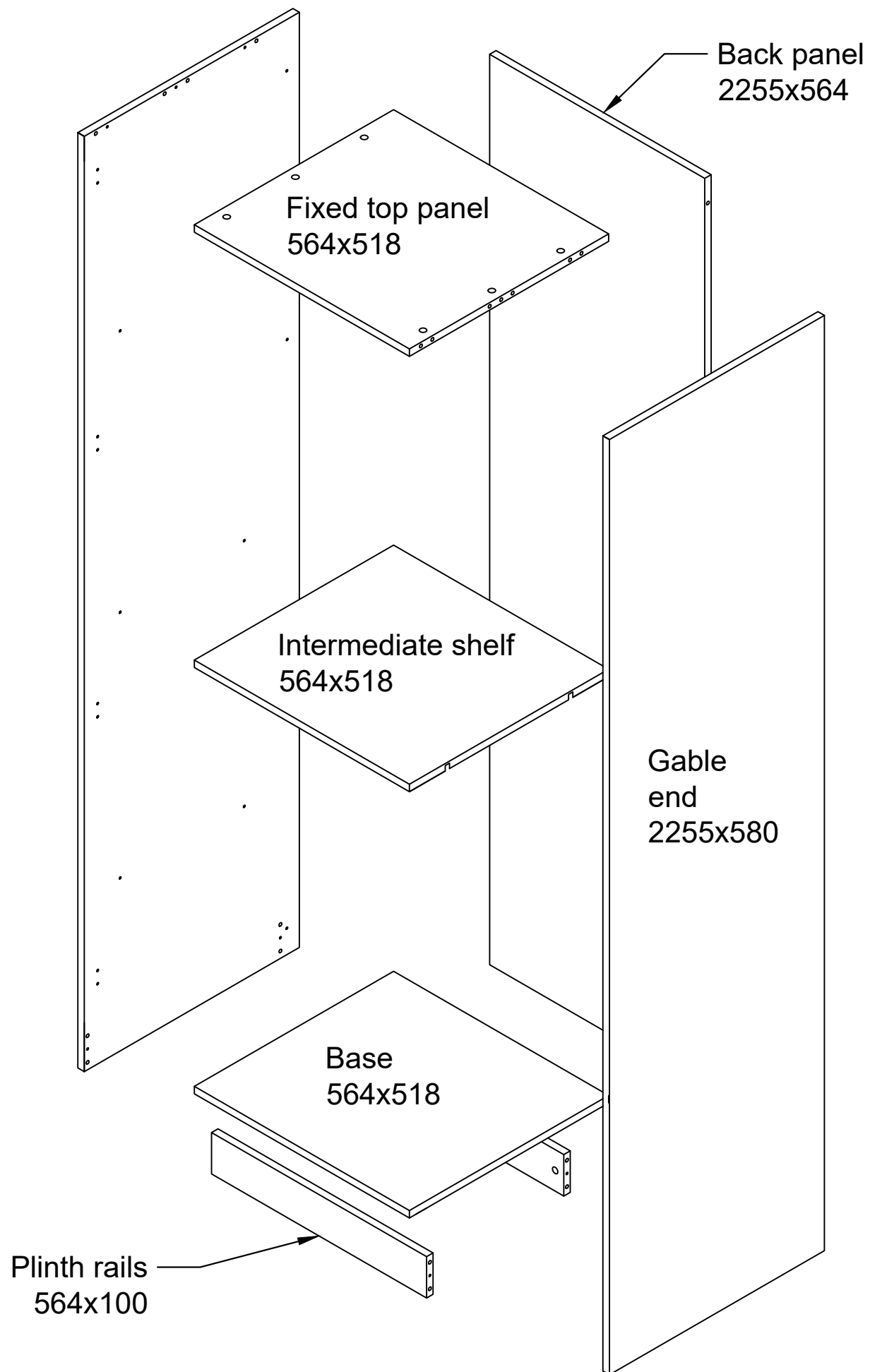

Tools required and fittings.

Tools Required

Tape measure
Electric drill/driver
3mm drill bit
Philips screwdriver bit
Hammer
Large philips screwdriver
Large flat screwdriver
Spirit level
Saw

Fittings Supplied (per robe)

	20no. 16x3,5 screw (28no. double robe)
	4no. 30x3.5 screw
	16no. 35x8 beech dowel
	30no. 35x6 dowel
	30no. 15x12 cam
	12no. 20x6 KD dowel
	12no. 20x15 KD cam (Colour varies)
	4no. adjustable bed leg
	2no. hanging rail end cups (4no. for double hanging)
	4no. hinges (8no. double robe)
	4no. hinge plates (8no. double robe)

Where shown screw in fixing onto your end panel

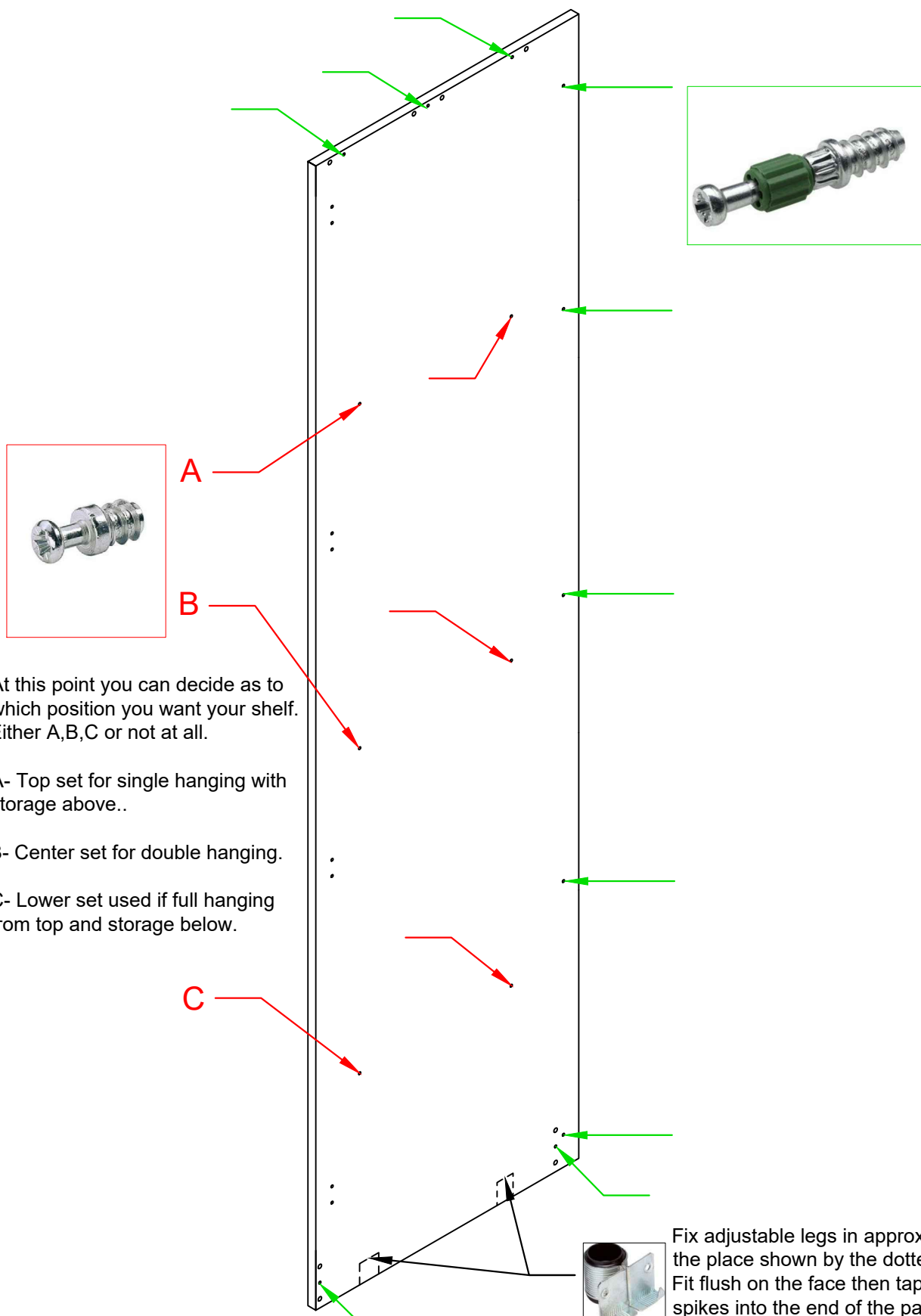

At this point you can decide as to which position you want your shelf. Either A,B,C or not at all.

A- Top set for single hanging with storage above..

B- Center set for double hanging.

C- Lower set used if full hanging from top and storage below.

Fix adjustable legs in approximately the place shown by the dotted line. Fit flush on the face then tap the spikes into the end of the panel then fix in place with 2no. 16x3.5 screws.

Step 2 : Insert 8mm dowels and screw on fixings



Screw on hinge plate to hinged end.
Note. picture shows hinge plate facing the front edge.

Hinge holes are only drilled on required ends. Left hand hung door shown.

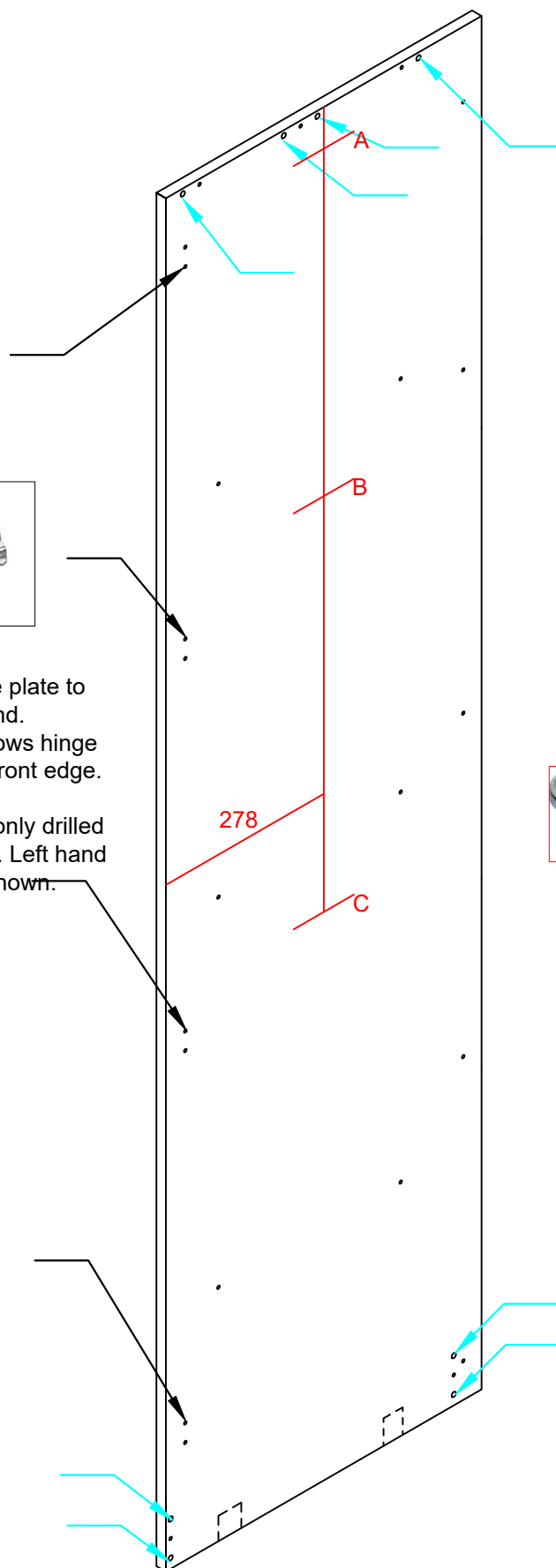

35x8 beech dowel where shown

In most cases dowels are already inserted into the various components

With your shelf position chosen you can now fix your hanging rail cups using 16mm screws. Depending on which position you have chosen drill a hole at dimensions given. Dimension is to the top most hole.

A- 50
B- 487
C- 1121



Insert fixings into top/bottom etc.

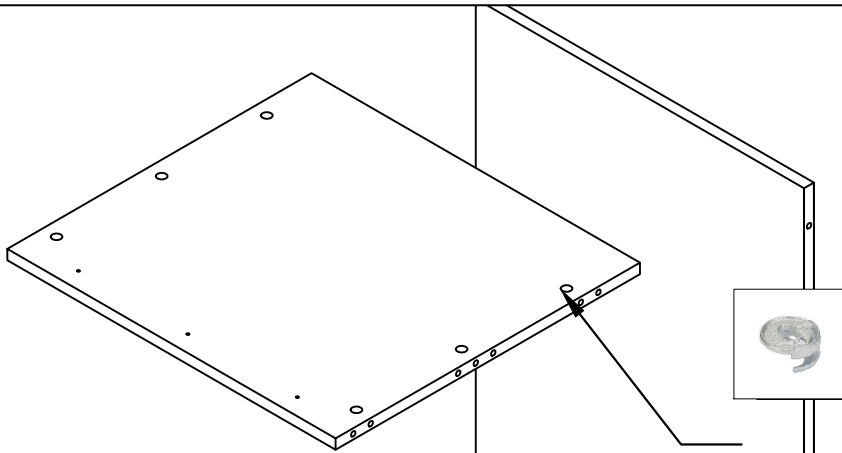

Insert 6no. cams into the holes on top, ensure arrow on cam is pointing to edge of board. Cams to outer most face.

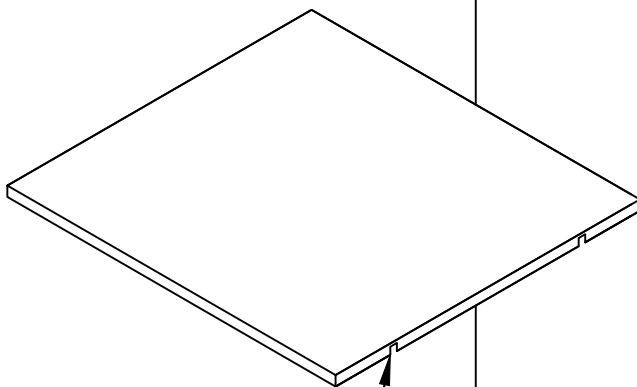

Insert 10no. cams into the back panel, ensure arrow on cam is pointing to edge of board. Cams to outer most face.



Tap adjustable cams into center shelf if required, ensure flat edge is inline with edge of shelf.

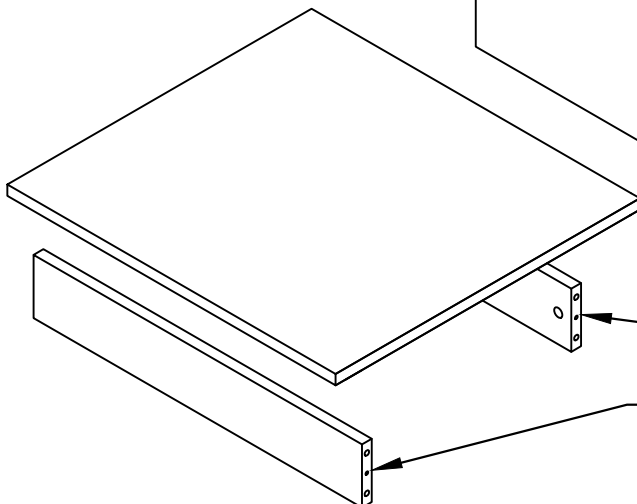

Insert 2 cams per plinth rail. Keep cams facing inwards.

Step 4: Assembly of robes (guide only)

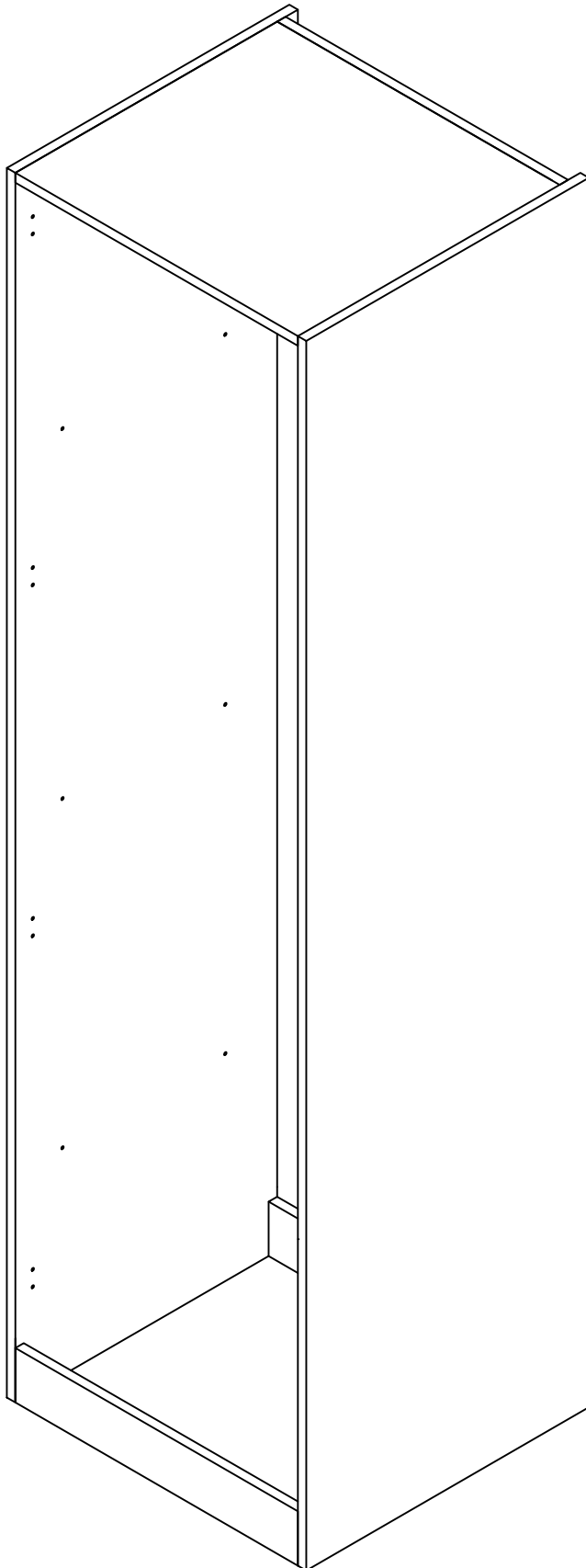

After adding all of the fittings to the various panels your robe can now be assembled. Below is a guide on how to do this.

1. Clear the floor area adjacent to where the finished robe will be installed.
2. Lay an end on the floor.
3. Fit the top, plinth rails and back by pushing down onto dowels and then using a large philips screwdriver tighten the cam.
4. Apply second end to the robe and tighten cams as previous.
5. Drill a 2mm hole to screw the back to the rear of the top and the rear plinth rail as required.
6. Scribe rear of end over skirting board if required.
7. Stand robe up.
8. Using a spirit level and large flat screwdriver for the adjustable bed legs level the robe.
9. Once level fix back to the wall (fixings not supplied).
10. If several robes are in a line they can be screw together if required.
11. Fit the bottom by dropping it into place on top of the plinth rails. Your shelf can be placed onto the KD dowels and then tightened into place with a turn of the KD cam screw.
12. Fit your robe rail.
13. Your ready for your doors.

Your robe is now fully assembled and ready for completion with any ironmongery you have chosen and/or cornice etc.

Fitting of the doors.

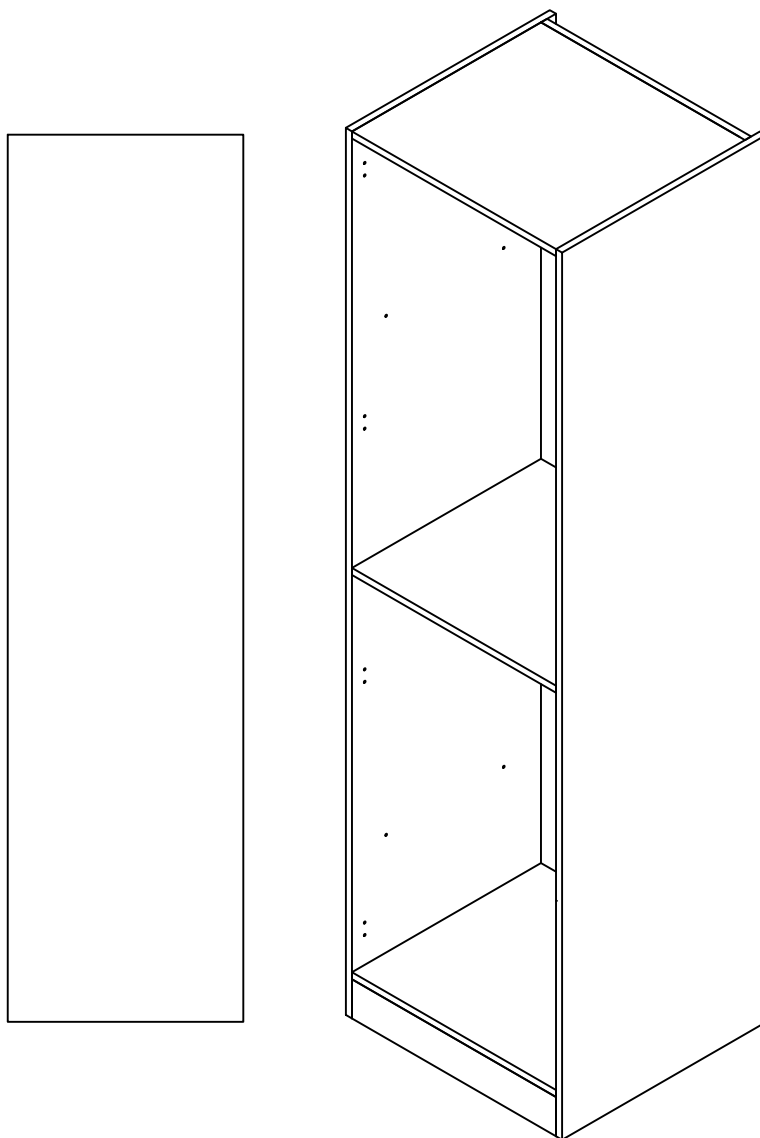

Lay door down on a clean flat area to avoid avoid damage to face of door.
Screw the hinge arms onto the doors using 2no. 16x3.5 screws per hinge. Hook the the arm to the front of the hinge plate then push it onto the rear of the plate until a click is heard,

Adjustment of the doors is simple through the hinge. Vertically this is done on the hinge plate, loosen the screws on the plate and slide up or down as required. Horizontally this is done on the hinge arm. Wind screw A in or out to adjust the door. Screw B will "push or pull " the door away from or closer to the robe carcass.

